



TOOLING FOR PARKER TRANSAIR COMPRESSED AIR PIPE



Tools

Product Features:

- Practical tools for the installation and extension of Transair® pipe systems.
- Presented in a carrying case or available as separate parts.



Tool Case

PART NO.	H (IN)	L (IN)
6698 00 05	12 7/8	11 3/8

This tool case simplifies the use and transportation of tools. It contains all the tools necessary for completing system installations from 1/2" to 2-1/2":

- Chamfer tool 6698 04 01
- Cutter for rigid pipe 6698 03 01
- Deburring tool 6698 04 02
- Drilling jig 6698 01 03
- Drill bits 6698 02 01 and 6698 02 02
- Marking tool 6698 04 03
- Spanner wrenches 6698 05 03

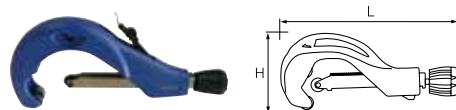

Pipe Cutter

PART NO.	USED FOR TRANSAIR® PIPE (IN)
6698 03 01	Ø 1/2" - 3"
EW08 00 03	Ø 4" - 6"

- Includes deburring tool.

Replacement Cutter Wheels

PART NO.	USED FOR TRANSAIR PIPE CUTTER
EW08 00 99	6698 03 01
EW08 00 04	EW08 00 03



Electric Pipe Cutter

PART NO.	USED FOR TRANSAIR® PIPE (IN)
EW08 00 V3	Ø 1-1/2" TO 6"

Replacement Cutter Blade

PART NO.	USED FOR TRANSAIR PIPE CUTTER
EW08 00 ALUS	EW08 00 V3



WARNING: This product can expose you to chemicals including Lead and Lead Compounds which is known to the State of California to cause cancer and birth defects or other reproductive harm. For more information go to www.P65Warnings.ca.gov

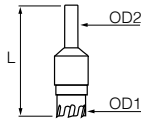

Drill Bits

PART NO.	OD1 (IN)	OD1 (MM)	OD2 (IN)	OD2 (MM)	L (IN)	USED FOR TRANSAIR® PIPE (IN)
6698 02 02	5/8	16	1/2	11	2 7/8	Ø 1"

Drill bit 6698 02 02 is required to install Ø 1" Transair® brackets.
Recommended to be used with any cordless drill with a 1/2" chuck.
Use with Transair drilling jig, 6698 01 03.

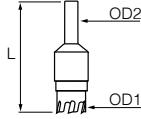

PART NO.	OD1 (IN)	OD1 (MM)	OD2 (IN)	OD2 (MM)	L (IN)	USED FOR TRANSAIR® PIPE (IN)
6698 02 01	1	22	1/2	13	2 3/4	Ø 1 1/2" - 2 1/2"

Drill bit 6698 02 01 is required to install Ø 1 1/2", Ø 2" and Ø 2 1/2" Transair® brackets. It is also used to create the two holes needed for double-clamp ring connectors when cutting to length Ø 2 1/2" Transair® pipe.
Recommended to be used with any cordless drill with a 1/2" chuck.

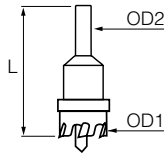

PART NO.	OD1 (IN)	OD1 (MM)	OD2 (IN)	OD2 (MM)	L (IN)	USED FOR TRANSAIR® PIPE (IN)
EW09 00 22	1	22	1/2	13	2 3/4	Ø 1 1/2" - 2 1/2"
EW09 00 30	1 3/16	30	1/2	13	2 3/4	Ø 3" - 4"
EW09 00 51	2	50	1/2	13	2 3/4	Ø 6"
EW09 00 64	2 1/2	63	1/2	13	2 3/4	Ø 6"

Drill bit EW09 is required to install Transair® direct feed brackets.
After drilling, it is important to deburr and clean the pipe.
Recommended to be used with any cordless drill with a 1/2" chuck.

Drill Bit Selection Chart

PART NO.	OD (IN)	OD (MM)	TOOL PART NO.
6650 00 00 04	2	50	6698 02 01
6650 00 00 16	2-1/2	63	6698 02 01
RA69 25 17	1	25	6698 02 02
RA69 40 25	1-1/2	40	6698 02 01
RA69 50 25	2	50	6698 02 01
RA69 63 25	2-1/2	63	6698 02 01
RA68 25N04	1	25	6698 02 02
RA68 40N04	1-1/2	40	6698 02 01
RA68 50N04	2	50	6698 02 01
RA68 50N08	2	50	6698 02 01
RA68 63N08	2-1/2	63	6698 02 01
RR63 L1N08	3	76	EW09 00 30
RR63 L3N08	4	101	EW09 00 30
RR63 L8N12	6	168	EW09 00 51
RR63 L8N16	6	168	EW09 00 64
6662 25 17	1	25	6698 02 02

PART NO.	OD (IN)	OD (MM)	TOOL PART NO.
6662 25 00	1	25	6698 02 02
6662 40 17	1-1/2	40	6698 02 01
6662 40 25	1-1/2	40	6698 02 01
6662 50 25	2	50	6698 02 01
6662 63 25	2-1/2	63	6698 02 01
6663 25 22	1	25	6698 02 02
6663 40 22	1-1/2	40	6698 02 01
6663 50 22	2	50	6698 02 01
6663 50 28	2	50	6698 02 01
6663 63 22	2-1/2	63	6698 02 01
6663 63 28	2-1/2	63	6698 02 01
6668 25 22	1	25	6698 02 02
6668 40 22	1-1/2	40	6698 02 01
6668 50 22	2	50	6698 02 01
6668 63 22	2-1/2	63	6698 02 01
6668 63 28	2-1/2	63	6698 02 01

WARNING: This product can expose you to chemicals including Lead and Lead Compounds which is known to the State of California to cause cancer and birth defects or other reproductive harm. For more information go to www.P65Warnings.ca.gov

6698 01 01

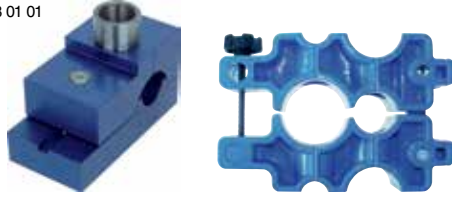

Drilling Jig

PART NO.	USED FOR TRANSAIR PIPE (IN)
6698 01 01	Ø 1" to 1-1/2"
6698 01 03	Ø 1" to 2-1/2"



Deburring Tool

PART NO.
6698 04 02

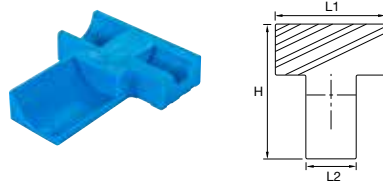

Marking Tool

PART NO.
6698 04 03

The marking tool is used as a guide for marking cut lengths on Transair® pipe. These marks indicate the insertion limits of the pipe into each fitting in order to ensure a good airtight connection and secure grip.



Chamfer Tool

PART NO.
6698 04 01

For 1/2", 1" and 1 1/2".



Pressurized System Drill Bit, BSPP

PART NO.	OD (IN)	OD (MM)	C (IN)	L (IN)
EA98 06 00	1/2	16.5	1/2	13



Spanner Wrenches

PART NO.
6698 05 03

Includes two tightening spanners.
Used to tighten 50mm and 63mm connectors.



Portable Lugging Tool Kit

PART NO.	VOLTAGE
EW01 00 02	14

This case contains: one portable tool, one 14V battery and battery charger. Jaws sold separately.

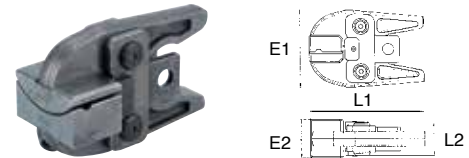

Jaws for Portable Lugging Tool

PART NO.	USED FOR TRANSAIR PIPE (IN)	USED FOR TRANSAIR PIPE (MM)
EW02 L1 00	3	76
EW02 L3 00	4	101
EW02 L8 00	6	168



14V Battery for Portable Lugging Tool

PART NO.	VOLTAGE
EW03 00 01	14

WARNING: This product can expose you to chemicals including Lead and Lead Compounds which is known to the State of California to cause cancer and birth defects or other reproductive harm. For more information go to www.P65Warnings.ca.gov

Tools for Stainless Steel

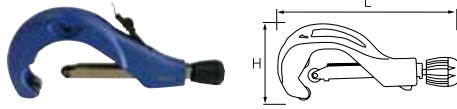

Pipe Cutter

PART NO.	USED FOR TRANSAIR® PIPE (IN)
6698 03 01	Ø 3/4" TO 3"
EW08 00 03	Ø 4"

■ Includes deburring tool.

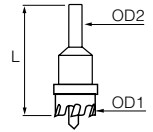

Drilling Tool

PART NO.	OD1 (IN)	OD1 (MM)	OD2 (IN)	OD2 (MM)	L (IN)	USED FOR TRANSAIR® PIPE (IN)
EW09 00 22	1	22	1/2	13	2 3/4	Ø 1 1/2" - 2"
EW09 00 30	1 3/16	30	1/2	13	2 3/4	Ø 3" - 4"

Drilling tool EW09 is required to install Transair® direct feed brackets. After drilling, it is important to deburr and clean the pipe. Recommended to be used with any cordless drill with a 1/2" chuck.



Spanner Wrenches

PART NO.	6698 05 03
----------	------------

Includes two tightening spanners. Used to tighten 1-1/2" and 2" connectors.



Deburring Tool

PART NO.	6698 04 02
----------	------------

Drilling Tool Selection Chart

PART NO.	OD (IN)	OD (MM)	TOOL PART NO.
RR89 M4N06 01	1-1/2	42	EW09 00 22
RR89 M6N06 01	2	60	EW09 00 22
RR89 L1N08 01	3	76	EW09 00 30
RR89 L3N08 01	4	101	EW09 00 30
RR89 M4N06 02	1-1/2	42	EW09 00 22
RR89 M6N06 02	2	60	EW09 00 22
RR89 L1N08 02	3	76	EW09 00 30
RR89 L3N08 02	4	101	EW09 00 30

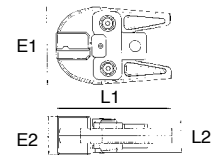

Jaws for Portable Lugging Tool

PART NO.	USED FOR TRANSAIR PIPE (IN)	USED FOR TRANSAIR PIPE (MM)
EW02 M4 00	1 1/2"	42
EW02 M6 00	2"	60
EW02 L1 00	3	76
EW02 L3 00	4	101

Portable Lugging Tool Kit

PART NO.	VOLTAGE
EW01 00 02	14

This case contains: one portable tool, one 14V battery and battery charger. Jaws sold separately.



14V Battery for Portable Lugging Tool

PART NO.	VOLTAGE
EW03 00 01	14

WARNING: This product can expose you to chemicals including Lead and Lead Compounds which is known to the State of California to cause cancer and birth defects or other reproductive harm. For more information go to www.P65Warnings.ca.gov



Electric Pipe Cutter

PART NO.	USED FOR TRANSAIR® PIPE (IN)
EW08 00 V3	Ø 4" to 6"



Dismounting Tool

PART NO.	EW11 00 01
----------	------------

Contains 1 key, 5 rings for dismounting Ø22 and 5 rings for dismounting Ø28

Replacement Cutter Blade

PART NO.	USED FOR TRANSAIR PIPE CUTTER
EW08 00 SSUS	EW08 00 V3



Maintenance Set

PART NO.	SEAL	OD (IN)	OD (MM)
EW10 N7 01	EPDM	3/4	22
EW10 N9 01	EPDM	1	28
EW10 N7 02	FKM	3/4	22
EW10 N9 02	FKM	1	28

Pipe Hangers for Stainless Steel

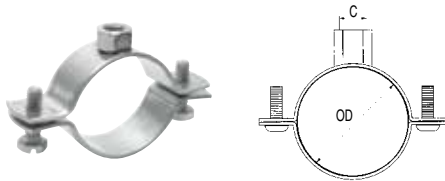

Pipe Hangers

PART NO.	OD (IN)	OD (MM)	THD SIZE (IN)
EX01 N7 01	3/4	22	3/8-16
EX01 N9 01	1	28	3/8-16
EX01 M4 01	1 1/2	42	3/8-16
EX01 M6 01	2	60	3/8-16
EX01 L1 00	3	76	3/8-16
EX01 L3 00	4	101	3/8-16

Maximum admitted static load: 200 daN

WARNING: This product can expose you to chemicals including Lead and Lead Compounds which is known to the State of California to cause cancer and birth defects or other reproductive harm. For more information go to www.P65Warnings.ca.gov

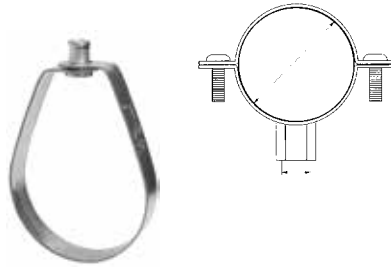

Pipe Hanger

PART NO.	OD (IN)	OD (MM)	THD SIZE (IN)	B (IN)	MATERIAL
EX01 V1200	8	220	1/2"-13	8-9/16	STEEL

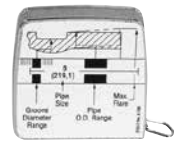

Groove Depth Measuring Tape

PART NO.	USED FOR TRANSAIR PIPE (IN)	USED FOR TRANSAIR PIPE (MM)
6698 V1203	8	220



Pipe Cutter

PART NO.	USED FOR TRANSAIR PIPE (IN)	USED FOR TRANSAIR PIPE (MM)
EW08 00 V3	8	220

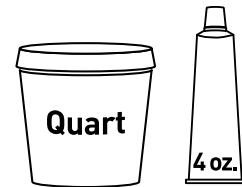

Lubricant

PART NO.	CONTAINER SIZE	QUANTITY	USED FOR TRANSAIR PIPE (IN)
6698 V1201	QUART	1	8
6698 V1202	4 OZ TUBE	12	8



Replacement Blades

PART NO.	USED FOR PIPE CUTTER
EW08 00 ALUS	EW08 00 V3



Dies for Roll Groover

PART NO.	USED FOR TRANSAIR PIPE (IN)	USED FOR TRANSAIR PIPE (MM)
EW02 V1200	8	220

Compatible with VE270FSD/271FSD roll grooving tools.
Grooving tool available through Sunbelt Rental

NOTICE Transair 8 inch pipe, connectors, and accessories are only available for sale in North/Central America.



exact

Pipe Cutting System



TWO NEW CORDLESS MODELS



NEW INFINITY SAW



PROFESSIONAL PIPE CUTTING POWER TOOLS

WHY CHOOSE?

exact Pipe Cutting System

- Unique Exact Method to Cut Pipes
- Safe, Accurate, and Fast
- Speed: Cut 6" Steel Pipe with an 1/8" Wall in Less than 20 Seconds
- Cut Steel, Plastic, Copper, Cast Iron, Stainless Steel, and Multi-Layer Pipes
- Improve Safety, Accuracy, and Speed on the Jobsite

PRO SERIES: PIPE SAWS FOR HEAVY DUTY PIPES

NEW!

Infinity Saw

Capacity Range*	14" – 73" with Standard Kit 73" + by adding chain segments
Steel Wall Thickness	.5"
Plastic Wall Thickness	1.7"
Motor	15 Amp
Weight	28 lb Shipping Weight 68 lb

*Additional Chain Segments Sold in 78" Increments

*Uses a Chain Tracking Mechanism to Facilitate the Cut



Standard Equipment: PipeCut Infinity Motor Unit & Cermet 165 Blade, 2 Shoulder Bags, Tensioner Device, Tensioner Device w/ Crank, Chain segments for attaching saw to pipe: 78" 2 pcs • 39" 1 pc • 20" 1 pc • 8" 2 pcs • 4" 1 pc, Allen Keys (2mm, 5mm)
*Diamond 165 Cut/Bevel Blade comes with INFINITY CUT/BEVEL Saw

3 Different Options

- **INFINITY:** Standard Kit with Manual Crank
- **INFINITY CUT & BEVEL:** Cuts & Bevels Cast/Ductile Iron & Cuts Multi-Layer Pipe
- **INFINITY PLUS:** Includes Gearbox for Cordless Drill Assisted Operation

PipeCut 220 Pro

Capacity Range	.8" – 8.7" OD Pipes
Steel Wall Thickness	.6"
Plastic Wall Thickness	1.4"
Motor	15 Amp
Weight	25 lb

Built-in Laser for Precise Cutting

"Traffic Light" Indicators Provide Overload Protection

Standard Equipment:

PipeCut 220 PRO Saw, TCT 165 Blade, Shoulder Bag, 4 Pipe Supports, Allen Keys (2mm, 5mm)

PipeCut 220 Pro Cut & Bevel

Capacity Range	.8" – 8.7" OD Pipes
----------------	---------------------

Cut & Bevel Ductile/Cast Iron at the Same Time

Also Includes: Diamond Cut Bevel Disc 165 mm and Specific Blade Guard for it



PipeCut 220 Pro



PipeCut 220 Pro Cut & Bevel

PipeCut 280 Pro

Capacity Range	2" – 11" OD Pipes
Steel Wall Thickness	.5"
Plastic Wall Thickness	2"
Motor	15 Amp
Weight	34 lb

Built-in Laser for Precise Cutting

"Traffic Light" Indicators Provide Overload Protection

Standard Equipment: PipeCut 280 PRO Saw, TCT 165 Blade, Shoulder Bag, 4 Pipe Supports, Allen Keys (2mm, 5mm)



PipeCut 280 Pro



PipeCut 360 Pro

Capacity Range	3" – 14" OD Pipes
Steel Wall Thickness	.5"
Plastic Wall Thickness	2"
Motor	15 Amp
Weight	36 lb
Built-in Laser for Precise Cutting	
"Traffic Light" Indicators Provide Overload Protection	

Standard Equipment: PipeCut 360 PRO Saw, TCT 165 Blade, Shoulder Bag, Heavy Duty Pipe Supports (2 Single, 1 Double), Allen Keys (2mm, 5mm)

PipeCut 360 Pro Cut & Bevel

Capacity Range	3" – 14" OD Pipes
Cut & Bevel Ductile/Cast Iron at the Same Time	
Also Includes: Diamond Cut Bevel Disc 165 mm and Specific Blade Guard for it	

PipeCut 460 Pro

Capacity Range	4" – 18" OD Pipes
Steel Wall Thickness	.5"
Plastic Wall Thickness	2"
Motor	15 Amp
Weight	39 lb
Built-in Laser for Precise Cutting	
"Traffic Light" Indicators Provide Overload Protection	

Standard Equipment: PipeCut 460 PRO Saw, TCT 165 Blade, Shoulder Bag, Heavy Duty Pipe Supports (2 Single, 1 Double), Allen Keys (2mm, 5mm)

STAINLESS STEEL SAWS

PipeCut 220 INOX

Capacity Range	.8" – 8.7" OD Pipes
Max Pipe Wall	.5"
Motor	15 Amp
Weight	25 lb
Stainless Steel Rollers and Blade Guard Touch Point	
Built-in Laser for Precise Cutting	
"Traffic Light" Indicators Provide Overload Protection	

Standard Equipment: PipeCut 220 INOX Saw, 140 INOX Blade, Shoulder Bag, 4 Pipe Supports, Allen Keys (2mm, 5mm)

PipeCut 360 INOX

for Stainless Steel Applications

Capacity Range	3" – 14" OD Pipes
----------------	-------------------



PipeCut 360 Pro



PipeCut 360 Pro
Cut & Bevel



PipeCut 460 Pro





WE CUT THE PIPES AND NOW WE'VE CUT THE CORD!

CORDLESS SAWS

170 Cordless Kit

Capacity Range	.6" – 6.7" OD Pipes
Steel Wall Thickness	3/16"
Plastic Wall Thickness	1/2"
Battery	18V 5.0 AH Lithium Ion
Charge Time	1 hour



Standard Equipment:
PipeCut 170
Cordless Pipe Saw,
(1) Cermet 140 Thin
Blade Installed, Pipe
Supports (4) small,
Battery Charger, (2)
Exact 18V Lithium-Ion
Batteries, Shoulder
Bag, Instructions, 5mm
& 2mm Allen Keys.

P400 Cordless Kit

Cut & Bevel PVC at the Same Time!

Capacity Range	2" – 16" OD Pipes
Plastic Wall Thickness	7/8" Cutting, 5/8" Cut & Bevel
Battery	18V 5.0 AH Lithium Ion
Charge Time	1 hour



Standard Equipment: PipeCut P400 Cordless Pipe Saw, (1) Cut+Bevel Blade Installed, (1) TCT P150 Blade, Pipe Supports (2) Single (1) Double, Battery Charger, (2) Exact 18V Lithium-Ion Batteries, Shoulder Bag, Instructions, 5mm & 2mm Allen Keys.



PipeCut 170E

Capacity Range	.6" – 6.7" OD Pipes
Steel Wall Thickness	.31"
Plastic Wall Thickness	.55"
Motor	9.2 Amp
Weight	12 lb

Standard Equipment: PipeCut 170E Saw, TCT 140 Blade, Shoulder Bag, 4 Pipe Supports, Allen Keys (2mm, 5mm)



PipeCut 220E

Capacity Range	.6" – 8.7" OD Pipes
Steel Wall Thickness	.31"
Plastic Wall Thickness	.55"
Motor	9.2 Amp
Weight	13 lb

Standard Equipment: PipeCut 220E Saw, TCT 140 Blade, Shoulder Bag, 4 Pipe Supports, Allen Keys (2mm, 5mm)

SPECIALTY SAWS

PipeCut P400

Cut and bevel at the same time

Capacity Range 2" – 16" OD Pipes

Plastic Wall Thickness 2"

Motor 8.4 Amp

Weight 36 lb

Standard Equipment: PipeCut P400 Saw, TCT P150 Blade, Cut & Bevel Blade, Shoulder Bag, Heavy Duty Pipe Supports (2 Single, 1 Double), Allen Keys (5mm)



PipeCut P1000

For large diameter plastic pipes

Capacity Range 2.3" – 40" OD Pipes

Plastic Wall Thickness 2.9"

Pipe Material Plastics (PP, PE, PVC, HDPE)

Motor 15 Amp

Weight 25 lb

Built-in Laser for Precise Cutting

Standard Equipment: PipeCut P1000 Saw, TCT 190 Blade, Shoulder Bag, 3 Pipe Supports, Allen Keys (2mm, 5mm)



PipeCut V1000

A new era for spiral duct cutting

Capacity Range 3" – 40" OD Pipes

Wall Thickness .06" – .023"

Motor 8.4 Amp

Weight 13 lb

Standard Equipment: PipeCut V1000 Saw, Cermet V155 Blade, Shoulder Bag, Allen Keys (2mm, 5mm)



PipeCut 360 AIR

Capacity Range 3" – 14" OD Pipes

Steel Wall Thickness 1.8"

Plastic Wall Thickness 1.8"

Motor 4.6 HP

Weight 59 lb

Required Air Pressure 90 PSI /140 CFM

Blades for Ductile Iron Diamond X165, Diamond X180

Standard Equipment: PipeCut 360 AIR SAW

BEVELERS

PipeBevel 220E

Capacity Range	1" – 8.8" OD Pipes
Wall Thickness	.0" – 0.4"
Angles/Degrees	30, 37.5, 45
Motor	8.4 Amp
Weight	13 lb

Standard Equipment: PipeBevel PB220E, Shoulder Bag, 2 Pipe Supports, Allen Key (5mm). NOTE: Cutting Head and Bevel Tips Sold Separately. Need to order Cutter Head Angle (30°, 37.5°, 45°) and order SS Bevel Tips (3 pack).

PipeBevel 360E

Capacity Range	4.4" – 14.4" OD Pipes
Wall Thickness	.0" – 0.4"
Angles/Degrees	30, 37.5, 45
Motor	8.4 Amp
Weight	13 lb

Pipe Supports, Shoulder Bag and Blade Guard



4 Pipe Supports



Heavy Duty Pipe Supports



Shoulder Bag



Blade Guard w/ Vacuum Port
BGTVP Small: 220 Pro
BGTVP Large: 280/360/460 Pro



Standard Equipment: PipeBevel PB360E, Shoulder Bag, 2 Pipe Supports, Allen Key (5mm). NOTE: Cutting Head and Bevel Tips Sold Separately. Need to order Cutter Head Angle (30°, 37.5°, 45°) and SS Bevel Tips (3 pack).

SAW BLADES/DISCS – 2 7/16" ARBOR

SKU	Material to Cut	Fit Saws#	Blade Size
TCT 140	Steel, Copper, Plastics	170E, 220E, & Pro Saws	5 1/2" (140mm)
TCT 165	Steel, Copper, Plastics	280, 360, 460, 220 Pro	6 1/2" (165mm)
TCT P-150	Plastics (PE, PP, PVC, etc.)	P400, P400 Cordless, P1000 & Pro Saws	5 29/32" (150mm)
TCT P-190	Plastics (PE, PP, PVC, HDPE)	P1000, 280, 360, 460	7 1/2" (190mm)
TCT P-250	Plastics (PE, PP, PVC, HDPE)	P1000	9 7/8" (250mm)
TCTZ-140	Steel, Copper, Plastic	170E, 220E, & Pro Saws	5 1/2" (140 mm)
Cermet 130	Steel, Stainless	280, 360, Air Saw	5 1/10" (130mm)
Cermet 140	Steel, Stainless, Copper, Plastics	170E, 220E, & Pro Saws	5 1/2" (140mm)
Cermet 140 Thin	Steel, Copper, Plastic	170 Cordless, & Pro Saws	5 1/2" (140mm)
Cermet 165	Steel, Stainless, Copper, Plastics	280, 360, 460, 220 Pro	6 1/2" (165mm)
Cermet 180	Steel, Stainless, Copper	280, 360, 460	7 2/25" (180mm)
Cermet V155	Thin Wall Ventilation Pipes	V1000	6 7/64" (155mm)
Cut Bevel Blade 190	Plastics (PE, PP, PVC, HDPE)	P1000	7 1/2" (190 mm)
Cut Bevel Blade	Plastics (PE, PP, PVC, HDPE)	P400, P400 Cordless, & P1000	5 53/64" (148mm)
ALU 140	Aluminum, Fusible Plastic	170E, 220E, & Pro Saws	5 1/2" (140mm)
ALU 165	Aluminum, Fusible Plastic	220, 280, 360, 460	6 1/2" (165mm)
ALU 180	Aluminum, Fusible Plastic	220, 280, 360, 460	7 2/25" (180mm)
Diamond X140	Cast Iron, Ductile (Nodular Cast Iron)	170E, 220E, & Pro Saws	5 1/2" (140mm)
Diamond X165	Cast Iron, Ductile (Nodular Cast Iron)	360 AIR & All Pro Saws	6 1/2" (165mm)
Diamond X180	Ductile Iron, Fiberglass	360 AIR & All Pro Saws	7 2/25" (180mm)
INOX 140	Stainless Steel	170E, 220E, INOX220 & All Pro Saws	5 1/2" (140mm)
INOX 140 Thin	Schedule 10 Stainless	170E, 220E, INOX220 & All Pro Saws	5 1/2" (140mm)
Diamond Cut/Bevel 140	Cut/Bevel Ductile/Cast Iron	220 PRO CUT/BEVEL	5 1/2" (140mm)
Diamond Cut/Bevel 165	Cut/Bevel Ductile/Cast Iron	360 PRO CUT/BEVEL	6 1/2" (162mm)

GUARANTEE WARRANTY

Guarantee Warranty terms effective January 1, 2020.

If the Exact PipeCut Saw becomes unusable due to material or manufacturing defects within the Warranty Term or *Extended Warranty Term, at our discretion, we will repair the Exact PipeCut Saw or supply an entirely new or factory reconditioned Exact PipeCut Saw at no charge.

Warranty Term

The Exact Tools Warranty Term is for 12 months from the date of purchase.

The Warranty is valid only if all of the following conditions are met:

1. Copy of a dated purchase receipt is returned to an Authorized Warranty Repair Center or has been uploaded to our website at the time of warranty registration.
2. The Exact PipeCut Saw has not been misused.
3. No attempt has been made to repair the saw by anyone other than technicians at an Authorized Warranty Repair Center.
4. The Exact PipeCut Saw has been used in accordance with the operating, safety, and servicing instructions provided in the manual.
5. The Exact PipeCut Saw has been delivered to an Authorized Warranty Repair Center within the term of the warranty.

Note: The Exact PipeCut Saw is to be shipped to the Authorized Warranty Repair Center freight prepaid. If the Exact PipeCut Saw is repaired under Warranty, the return shipment will be made freight prepaid. If the Exact PipeCut Saw is not repaired under Warranty, the return shipment will be made freight collect.

Please Note: The following items or services are excluded from Warranty claims:

Saw Blades, Overload Protection Fuse, Carbon Brushes, Gripping Unit Wheels, Blade Flange, Attachment Flange 90mm, Pulling Flange Washer, Normal Wear and Tear, Power Cords, Adjustment of Adjustment Wheel, Damage due to: misuse, accident, water, fire or physical damage.

exact

Pipe Cutting System

www.exacttools.com

Exact Pipe Tools, Inc.

A Wholly Owned Subsidiary of Exact Tools, OY

3465 S. Arlington Road,
Suite E #312 • Akron OH 44312

Email: nasales@exacttools.com

Ph: 844.392.2800

Ph: 330.922.8150

Fx: 888.607.9648



WATCH OUR
DEMONSTRATION



VISIT OUR WEBSITE
EXACTTOOLS.COM



BRAND	GROOVER MODEL	ROLLER PART NUMBER	NOTES
VICTAULIC	VE272SFS	RP08272012	Parker approved and tested
VICTAULIC	VE270SFD	RP08272012	Parker approves and tested
VICTAULIC	VE416FS	RP08416012	Not tested
VICTAULIC	RG3212	RP08321212	Not tested
VICTAULIC	VE460	RPQ1460012	Not tested

RIGID	MODEL # 918	WILL NOT WORK DO NOT USE
--------------	--------------------	---------------------------------



Dies for Roll Groover

PART NO.	USED FOR TRANSAIR PIPE (IN)	USED FOR TRANSAIR PIPE (MM)
EW02 V1200	8	220

Compatible with VE270FSD/271FSD roll grooving tools.
Grooving tool available through Sunbelt Rental